

# Harrow Parcel Box – Installation Guide (Temporary Addendum)

ILP-3041

Use alongside the Miami installation instructions (core method is the same: front removal, wall integration, fixing, etc.).

The sections below highlight the Harrow-specific differences you need to follow during installation.

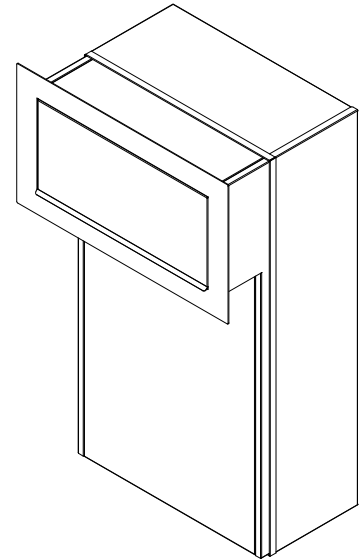

## At a Glance

- **Main difference:** adjustable rear section (set flush to wall depth or extend for capacity).
- **Chute:** extendable to match the box depth
- **Weatherproofing:** apply external-grade sealant to the join between the front and the rear section.
- **Final check:** rear section fixed, chute secured, sealant applied, front panel refitted (per Miami guide).

## 1. Key Difference – Adjustable Depth Design

The Harrow parcel box features an extendable rear section, allowing you to:

- Install the unit flush with the wall thickness (clean, architectural finish)
- Or extend it to maximise internal capacity

### Installation options

#### Option A – Flush installation (recommended for aesthetics)

- Adjust rear section to match wall depth
- Front sits clean and aligned with wall face

#### Option B – Extended installation (maximum capacity)

- Extend rear section fully or partially
- Increases parcel storage volume

## 2. Adjusting the Rear Section

1. Position the parcel box within the wall opening
2. Extend or retract the rear section to desired depth
3. Ensure alignment is square and level

### Securing the rear section

- We recommend to fix using screws through both sides of the unit
- Tighten securely once desired depth is set

### Important (sealant)

- Apply external-grade sealant along the joint between the extendable front and rear bottom section.

## 3. Chute Assembly & Adjustment (Harrow-specific)

The Harrow chute is extendable, designed to match the depth of the box.

### How it works

- The anti-theft chute extends in line with the rear section
- Short box = short chute
- Extended box = extended chute

## 4. Installing the Chute

1. Extend the chute to match the internal depth.
2. Secure the chute using the fixing screws provided.
3. Check movement:
  - flap operates freely
  - anti-theft function is not obstructed

## 5. Final Checks

Before completing installation:

- Rear section securely fixed
- Chute aligned and tightened
- Sealant applied
- Front panel refitted correctly (as per Miami guide)

## 6. Positioning Guidance (Best Practice)

- Ensure unit is level and square
- Maintain clean brickwork or wall finish around front face
- Avoid over-compressing the structure when fixing into wall

### What this achieves

- Flexible installation depending on property type
- Clean architectural finish when flush
- Increased capacity when extended
- Maintains anti-theft functionality in all configurations

For all remaining steps not covered here (front panel removal/refit, fixing method, wall integration details), follow the Miami installation instructions.

# Miami Installation Instructions

## Choosing a suitable location

The Miami/Miami II Parcel Letter box can be either mounted into a timber fence or built into a brick or block wall. You will need to install it in a location that is easily accessible.

Ideally Miami would be mounted in a fence-type scenario and Miami II would be fitted into a wall, however this could vary on a case-by-case basis.



**Please note:** For maximum security, we recommend an install height of approximately 120cm



**Please note:** These installation instructions are for guidance only. You may need to adapt how the item is installed to suit your situation.

## Removing the Front Panel for Installation

1. Open the front parcel door

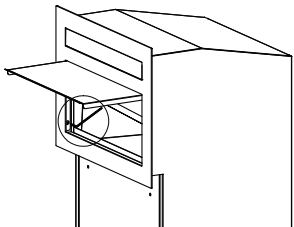

2. Unscrew the bolts on the left and right side pictured below

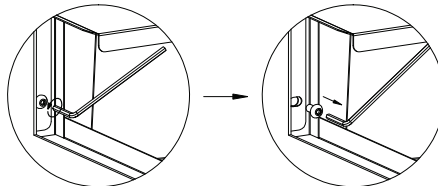

3. The front panel should now be removable

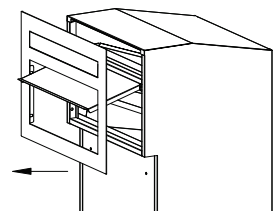

**Continue reading for installation instructions**

## Timber Fence Installation

## Brick Wall Installation

### Tools required

Drill + Timber drill bit (Masonry bit for brick), Tape measure, Jigsaw, Pencil, Spirit level

1. Measure the box parcel chute opening, mark and cut a slightly larger hole into the fence using a jigsaw.

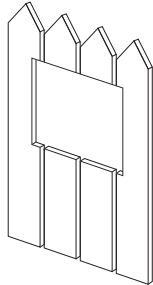

2. Slide the parcel box through the hole from the rear of the fence. Fix it to the fence with the screws provided using the 4 pre-drilled holes in the front of the back box. (for hardwood fences, it is easier to pre-drill the screw holes). This step will be easier with two people.

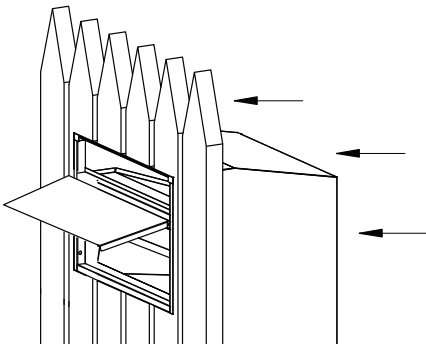

3. Attach the front panel by inserting the bolt you took out prior to commencing fitting.

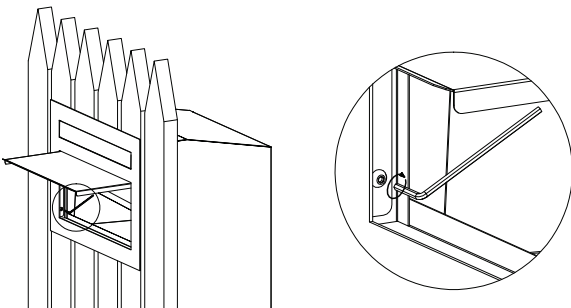

**Please note:** depending on the depth of your fence you may need to put spacer between the back of your fence and the parcel box to ensure the front of the parcel box is flush with the front of the fence.

1. Build the brickwork up to the desired level and set the back box in place.
  - ↳ Plain brick walls – the front should sit flush with the wall.
  - ↳ Rendered walls – set the back box forward to allow for the render thickness

2. Complete the remaining brickwork around the Parcel Letter Box.

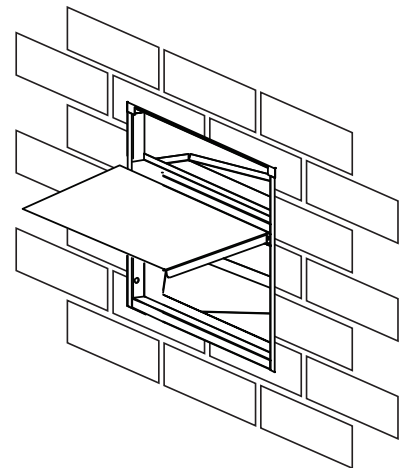

3. Once the brickwork and any rendering has been completed, attach the front panel by inserting the fixing bolts.

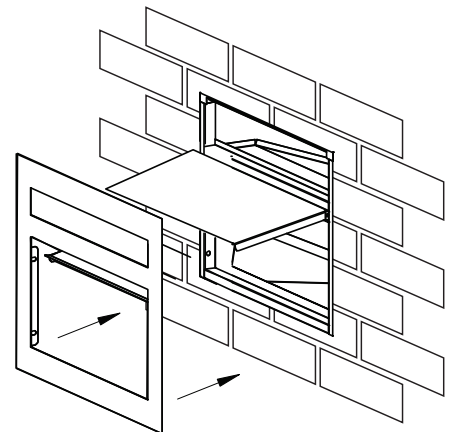

## Ground-mounted

Depending on your preference you may choose to bolt the parcel box to the floor, even if it is also being installed through a fence or even a wall.

1. Set the parcel box in the desired location.
2. Open the retrieval door and mark the four pre-drilled holes at the bottom.
3. Remove the parcel box and drill holes in the marked places, observing the correct diameter and depth, which needs to be 12mm wide and 60mm deep.
4. Re-position the Parcel Box and insert the bolts and washers and tighten the box securely to the ground.

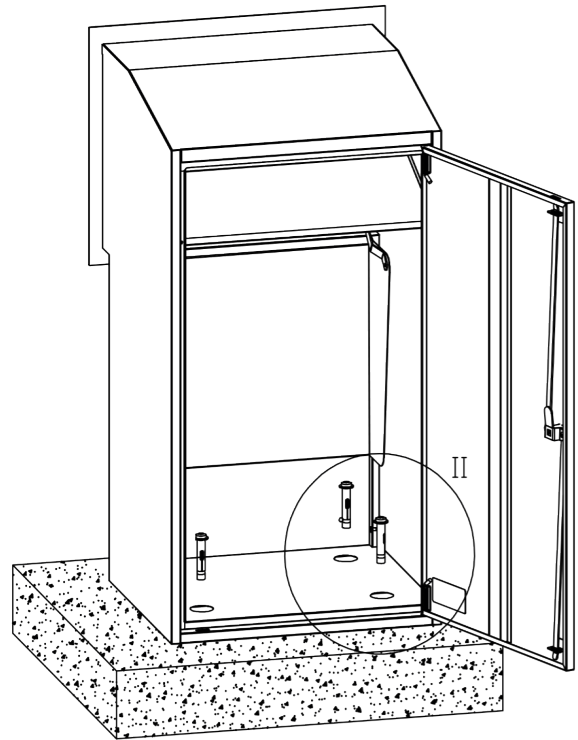
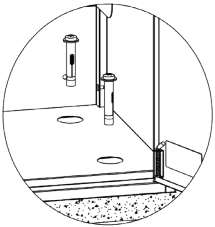

## Using your Parcel Box

The door offers an easy and convenient means of retrieving your parcels and mail.

Parcels can be delivered via the front chute. The courier simply opens the chute, places the parcels inside and then closes the chute. The parcel will fall into the retrieval area at the bottom.

If the parcel is too big, you can give the pin number to the courier, for them to access the secure compartment.